

FORM No. 1.

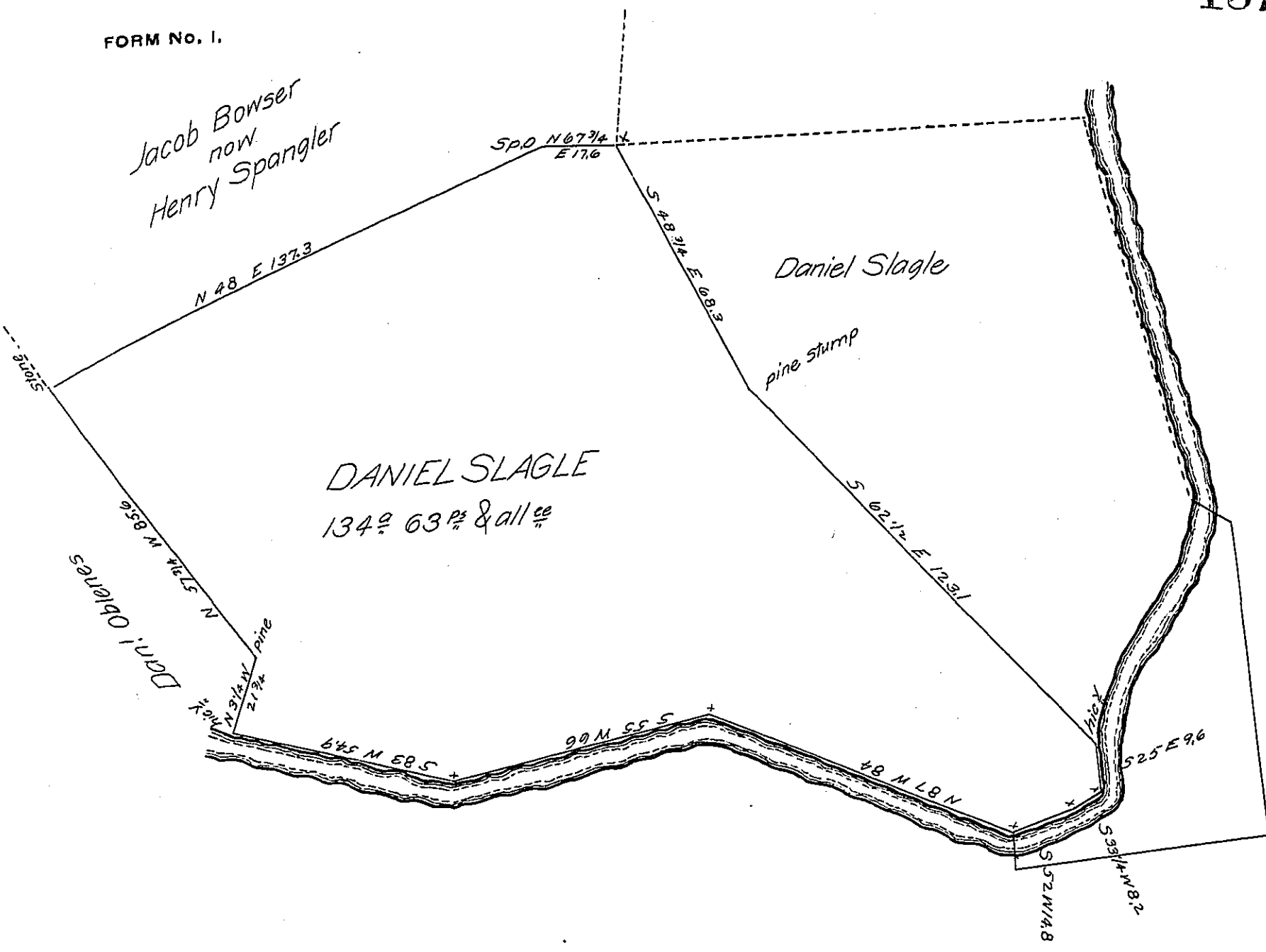

Situate in Reading Township Adams County being part of 221^{1/2} 112^{1/2} & all^{1/2} Surveyed Jan^y 8th 1818 by order of Survey to Daniel Slagle No. 5138 dated August ~~25th~~ 26th 1768 divided from the residue same day for Daniel Oblenes containing one hundred & thirty four acres Sixty three perches & all^{1/2} Daniel Slagle took 2 warrants dated Dec^r 15th 1792^{one for 30^{1/2} & one for 180^{1/2}} which appears to have been taken for 234^{1/2} of which this is a part (See return of the whole tract)

To Rich^d T. Leech Esq^t
Surveyor Gen^l

Sam^l Sloan D.S.

IN TESTIMONY that the above is a copy of the original remaining on file in the Department of Internal Affairs of Pennsylvania, made conformably to an Act of Assembly approved the 16th day of February, 1833, I have hereunto set my Hand and caused the Seal of said Department to be affixed at Harrisburg, this thirteenth day of March 1906

Isaac B. Brown
Secretary of Internal Affairs.